

NEW

# FLEXIBLE TIERED

# SEATING

A system that sits perfectly  
with your event plans

**nec**  
the**nec.co.uk**

Take a seat...  
We've got some  
big news for you

**Fixed seating and set configurations can often restrict your creativity and vision for your events.**

Now there's a faster, more flexible and cost-effective way to create the auditorium layout you want, not the one you have to

work around – with our new retractable tiered seating system. Coordinating perfectly with our flat floor seating, there are seven tribunes of 273 quality seats available so you can comfortably seat thousands of delegates in any

configuration to suit the size and style of your event. Plus, as the seats **extend and retract in just 5 minutes** – they can be deployed in just a fraction of the time required for demountable seating and at a fraction of the cost too.

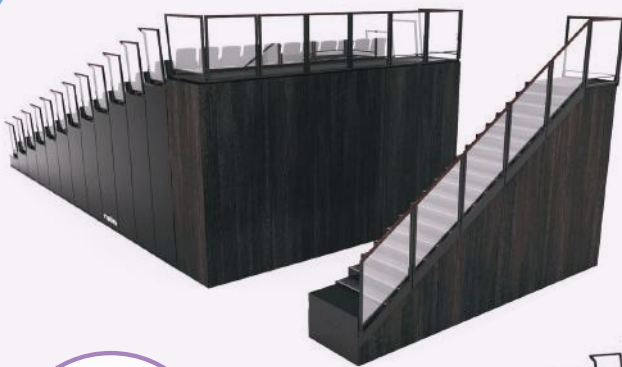

## Flexible

All tribunes can be used in any of our halls, are **completely mobile** and can even be split into two for increased flexibility

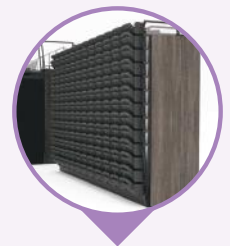

## Faster

Once in position, the seats extend and retract in under **5 minutes** allowing you to work smarter and faster

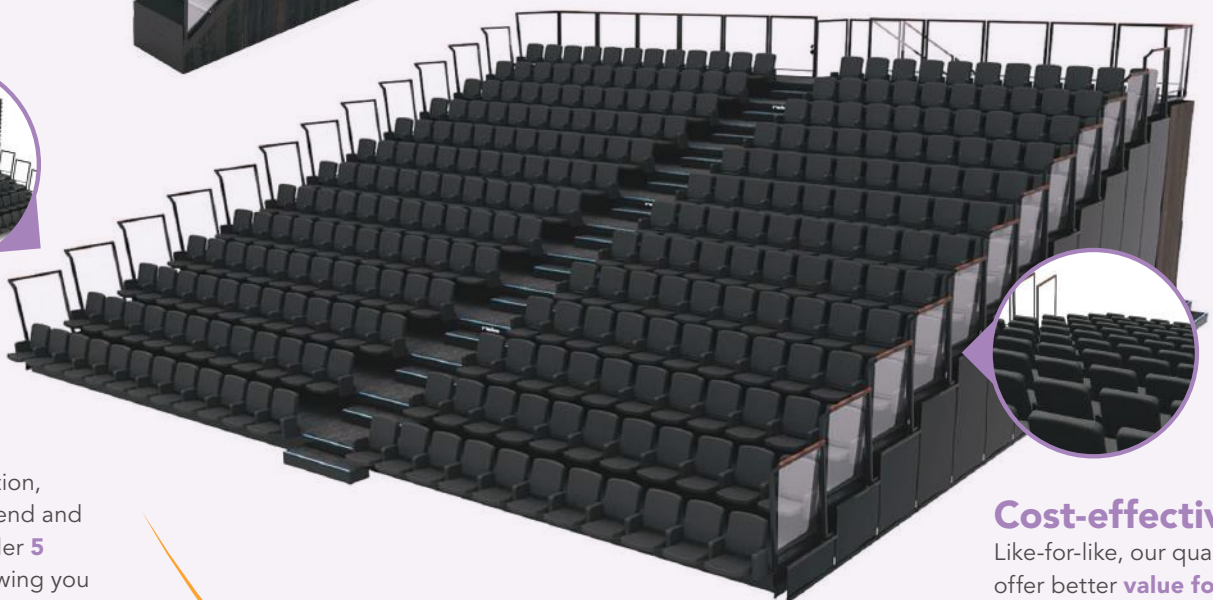

## Cost-effective

Like-for-like, our quality seats offer better **value for money** than demountable seating

# THE BEST SEATS IN THE HOUSE...

Not only is our new seating flexible and cost-effective but they're high quality, comfortable and look great too...

Enhancing the event experience and enabling better focus, our seats will provide your delegates with clear sightlines, better stage views, easy access and ample leg room to ensure their ultimate comfort and engagement throughout the event. The stylish smart grey exterior also ensures they will complement your clients' brand, quality and image.



## Features:

- Seven tribunes of 273 seats
- Each tribune can be split in two if required
- Detachable rear loading staircase for faster loading
- LED lighting on stairs for safe delegate access and exit
- Wood effect panels on rear
- Padded and upholstered seats for delegate comfort
- Fully carpeted throughout

## FLEXIBLE AND ADAPTABLE EVENT SPACE IN JUST 5 MINUTES



**Not only can you create the auditorium layout you want but as the seats extend and retract in just 5 minutes, you have the freedom to adapt the space to suit its purpose at any time during the event.**

Picture this... before coffee break your event space is an auditorium for 1000 delegates, after break it's a large open space for a product launch and networking.

***Anything is possible...***

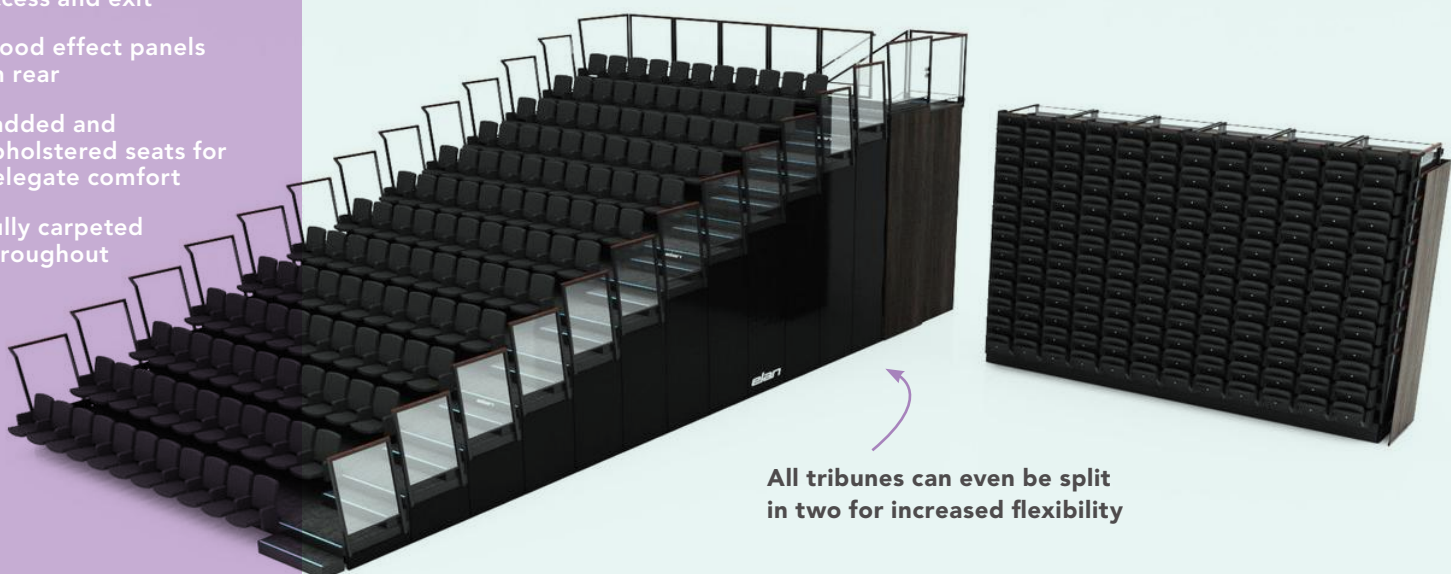

**All tribunes can even be split in two for increased flexibility**

# WHAT WILL YOU CREATE?

\*Example auditorium layouts

800

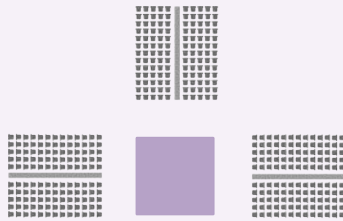

1,000

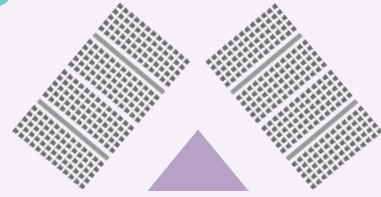

1,250

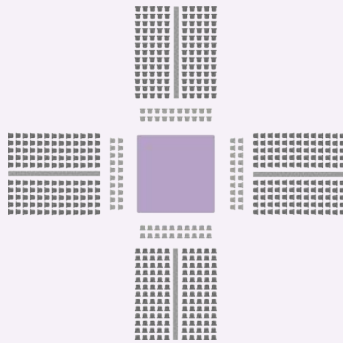

1,500

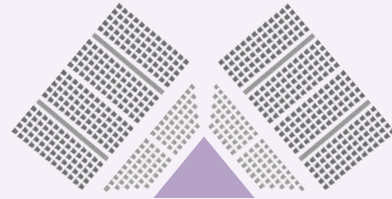

2,100

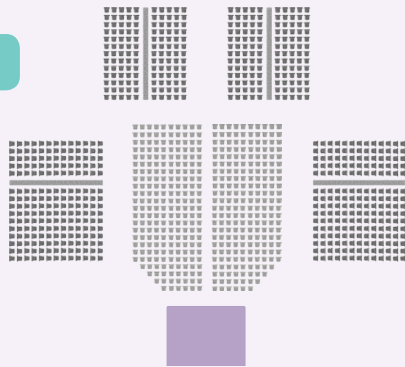

2,500

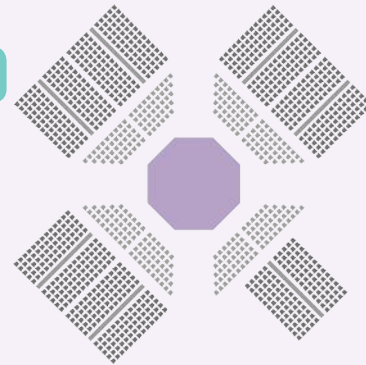

2,575

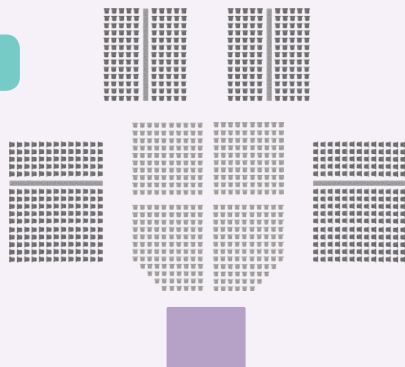

2,700

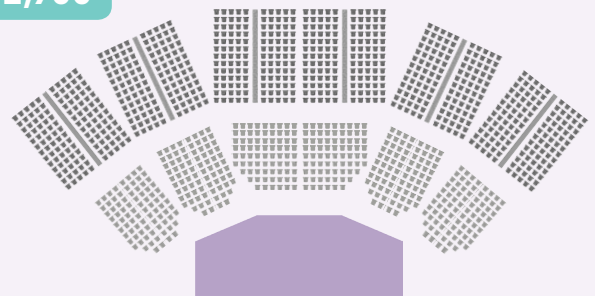

3,000

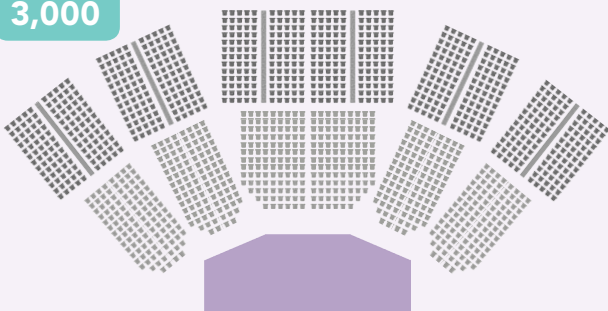

3,050

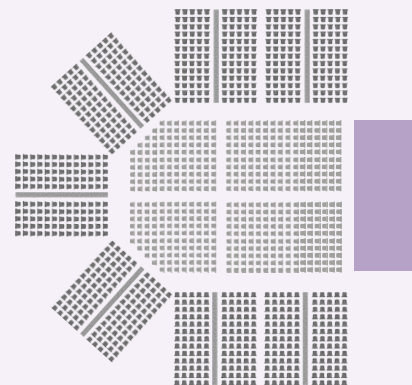

SIT BACK AND RELAX – YOU'VE GOT EVERYTHING YOU NEED WHEN YOU CHOOSE THE NEC

0121 767 2782 | [nec-conferences@necgroup.co.uk](mailto:nec-conferences@necgroup.co.uk)

\* Layouts are based on an event in Hall 12